

Technical Specification – Alloy Bow Shackles



Bow and pin high tensile steel – Grade 6

Generally to US Fed Spec RRC-271

Hot dip galvanized

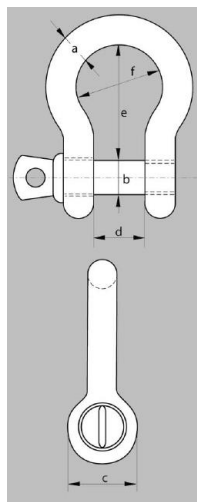

working load limit	diameter bow	diameter pin	diameter eye	inside width	inside length	width bow	product code	weight each
tons	a mm	b mm	c mm	d mm	e mm	f mm		kg
0.50	6	8	16	12	29	20	12032C	0.06
0.75	8	10	19	13.5	31	21	12033C	0.10
1.00	10	11	23	17	37	26	12034C	0.16
1.50	11	13	27	19	43	29	12035C	0.22
2.00	13	16	30	20	48	33	12036C	0.36
3.25	16	19	38	27	60	43	12037C	0.76
4.75	19	22	46	32	71	50	12038C	1.23
6.50	22	25	53	36	84	58	12039C	1.79
8.50	25	28	61	43	95	68	12040C	2.57
9.50	28	32	68	46	108	74	12041C	3.75
12.00	32	35	76	51	119	82	12042C	5.32
13.50	35	38	84	57	133	92	12043C	7.19
17.00	38	42	92	60	146	98	12044C	9.44
25.00	45	50	106	73	177	127	12045C	15.40
35.00	50	57	119	83	197	138	12046C	20.06
55.00	65	70	145	105	260	185	12048C	41.40